



# VASANTRAO KALE

## HOMOEOPATHIC MEDICAL COLLEGE & HOSPITAL

P-12, M.I.D.C., BARSHI ROAD,  
LATUR. – 413 531 (MAHARASHTRA)  
Ph. : (02382) 221389, Fax : (02382) 222523  
e-mail: vkhmclatur@gmail.com  
kspmsshmclatur@gmail.com  
Website: www.vkhmclatur.com

Ref. :HMC/

/ 2022 - 2023

Date : / / 2023

### Infrastructure requirements of a Homoeopathic College

#### (For intake Capacity from 61 to 100 Students)

Sr. No.	Particulars	Built up area (in sq.mt.)		
		Required	Existing	Deficient
1	<b>Administrative section</b> :- This shall includes Principal Room, Reception, Visitors Room, Committee Room, Administration and Account Section, Record Room, Separate Toilet for male and female.	150	91.82	--
2	<b>Lecture Halls</b> :- there shall be 5 Lecture Halls with capacity to accommodate 100 students with proper facilities for Electricity, Audio – Visual Aids, Fans/Coolers with separate toilet for Boys and Girls on Each Floor.	500	397.18	--
3	<b>Seminar / Examination Hall</b>	150	204.32	--
4	<b>Central Library</b> with sitting capacity of atleast50-60 students with reading room for teachers, separate reading room for P.G students, Librarian Room, Library shall have atleast 2000 Books on prescribed subjects. The Library shall have newspaper periodical, journal (specifically for the subject to be taught).	120	204.38	--
5	<b>Teaching Department -</b>			
	(a) <b>Anatomy</b> with a well ventilated dissection hall with wash basin, storage for cadaver and museum with facility of histology demonstration.	90	127.74	--
	(b) <b>Physiology</b> with separate laboratories for physiology and Biochemistry, Museum and Demonstration room.	90	85.94	--
	(c) <b>*Homoeopathic Pharmacy</b> Laboratory with Museum cum Demonstration room.	90	62.71	--
	(d) <b>Pathology Laboratory</b> with Museum cum Demonstration room.	90	62.71	--
	(e) <b>Forensic Medicine &amp; Toxicology</b> Museum cum Demonstration room.	60	43.66	--
	(f) <b>Community Medicine</b> Museum cum Demonstration room.	60	43.66	--
	(g)* <b>Practice of Medicine</b> Museum Cum Demonstration room.	60	123.10	--
	(h) <b>Gynecology&amp; Obstetrics</b> Museum Cum Demonstration room.	60	43.66	--
(i) <b>Surgery Museum</b> Cum Demonstration room	60	52.33	--	

	(j) * <b>Homoeopathic MateriaMedica</b> Museum Cum Demonstration room.	60	45.89	--
	(k) * <b>Organon of Medicine</b> including History of Medicine Museum cum Demonstration room.	60	45.89	--
	(l) * <b>Repertory</b> with computer lab & Demonstration room.	60	45.89	--
6	<b>Common Rooms for Boys and Girls</b> with adequate sitting arrangement and locker	40	32.52	--
7	<b>Canteen Facility</b> in the college premises.	75	81.05	--
	<b>Total</b>	<b>1875</b>	<b>1794.45</b>	

(Note : The said space requirement shall not be applicable for the colleges established prior to notification of HCC, Regulation – 2013. However, it is mandatory to mention the actual available infrastructure).

Principal  
**Vasant**rao Kale Homoeopathic  
 Medical College & Hospital M.I.D.C.  
 Latur

(24)  
III

# MIDC



MAHARASHTRA INDUSTRIAL DEVELOPMENT CORPORATION  
(A Government of Maharashtra Undertaking)

Phone: 632 54 51-3  
Grams: ARBADEV  
Telex: 011-2789

Regional Office,  
Opp. Subhan Talkies,  
Near Holy Station Road,  
Aurangabad

Marol Industrial Area,  
Mahakali Caves Road,  
Andheri (East),  
BOMBAY-400093.

By Regd. Post A. D.

No. LTR/ICA/A/400/P-2/395

Date: 2/2/1988

Subject: Latur Industrial Area—  
Allotment of land at—

Read: Application dated the 29th day of June, 1988 received  
from Smt/Messrs. Rishabh Shikshan Prasarak Mandali.

### ORDER

Sanction is hereby accorded to the allotment of land admeasuring  
2,000 square metres comprising of plot (s) No. (s) P-12  
from Latur Industrial Area to—

(i) Shri/Smt./Kumari \_\_\_\_\_  
trading as Proprietor under the name of M/s. \_\_\_\_\_  
having his/her  
office at \_\_\_\_\_

(ii) Sarvasbri \_\_\_\_\_  
carrying on business in partnership under the firm name & style of  
M/s. \_\_\_\_\_  
having their office at \_\_\_\_\_

(iii) M/s. Rishabh Shikshan Prasarak Mandali  
a Company incorporated under the Companies Act, 1956 having its registered  
office at \_\_\_\_\_

subject to the payment of the premium of Rs. 20,000/- calculated at the rate  
Rs. 10/- per square metre and subject to the following conditions:-

- (1) The allotment is valid to set up an unit for manufacture of school building and for  
sub-products specifically permitted from time to time.  
~~This shall be subject to the restrictions applicable or imposed by the Directorate of  
Industries State or Central Govt. in this behalf.~~
- (2) The amount of earnest money received with the application will be appropriated  
towards the amount of premium. The allottee shall pay the sum of Rs. 20,000/-  
(Rupees Twenty thousand only) being the balance amount of the  
premium within a period of 30 days from the date of receipt of this order.
- (3) ~~In case the allottee fails to pay the balance amount of premium within the period mentioned  
above, the allotment shall be liable to be cancelled without further notice.~~
- (4) ~~In the event of the allotment being cancelled as aforesaid, the Corporation will be entitled  
to forfeit the whole of the earnest money received with application.~~
- (5) The terms and conditions of allotment of land will be those as contained in the standard  
form of Agreement to Lease and the Lease annexed thereto and are in substance as follows:-

Principal  
**Vasant Rao Kale Homoeopathic Medical College & Hospital M.I.D.C.**  
Latur

Principal P.T.O.  
**Vasant Rao Kale Homoeopathic Medical College & Hospital M.I.D.C.**  
Latur

# Latur Industrial Area.

Village - Varavanti Tg. Dist. Latur

Scale 1:2000

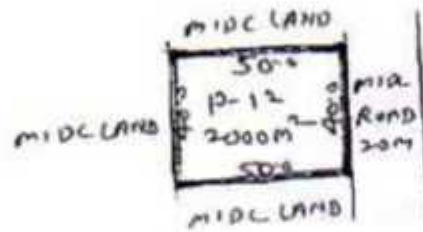

Corried by  
R/S

(R. S. Gote)

वसंतराव  
 खेकरजी  
 किसान शि. अ. मंडळ  
 बोवगान (कादने)  
 ता. जि. लातूर.



G. M. PARMAR.)  
Regional Officer.

Maharashtra Industrial Development Corporation,

Principal

Vasantao Kale Homoeopathic  
Medical College, M.I.D.C., Latur

Principal

Vasantao Kale Homoeopathic  
 Medical College, M.I.D.C., Latur  
 Vasantao Kale Homoeopathic  
 Medical College & Hospital M.I.D.C.  
 Latur

26

III

# MIDC



Marol Indl. Area,  
Mahakali Caves Marg,  
Marol, Andheri (E),  
Bombay-400 093.

By R. P. A. D.  
No MIDC/

Date : 14/8/96

31/11/96 1657

Sub :- Industrial Area  
Allotment of land at ..

Ref :- Application dated the Lotur days of  
received from

Shri/Smt/Messrs 12 the

11/11/11 Rishabh Shikhan

Pranav Mandal

### : O R D E R :

Sanction is hereby accorded to the allotment of land admeasuring \_\_\_\_\_ sq. Mtrs. comprising of Plot No. \_\_\_\_\_ From \_\_\_\_\_ Study Industrial Area to :

i) Shri/Smt./Kumari 3-70 1-61 Lotur  
trading as proprietor under the name of M/s. \_\_\_\_\_

having his/her office at \_\_\_\_\_

ii) Sarvashri \_\_\_\_\_

carrying on business in partnership under the firm name and style of M/s \_\_\_\_\_

having their office at \_\_\_\_\_

iii) M/s. \_\_\_\_\_  
a Company incorporated under the Companies Act, 1956 having its registered office 11/11/11 Rishabh Shikhan Pranav Mandal

~~\_\_\_\_\_ & \_\_\_\_\_ incorporated under the society's~~  
~~\_\_\_\_\_ having its registered office at \_\_\_\_\_ (this~~  
~~is a Diot, Lotur.~~

Subject to the payment of the premium of Rs. \_\_\_\_\_ calculated at the rate of Rs. \_\_\_\_\_ per sq. Mtrs and subject to \_\_\_\_\_ conditions :-

20/-

Principal  
Vasantao Kale Homoeopathic  
Medical College & Hospital M.I.D.C.  
Latur  
Principal  
Vasantao Kale Homoeopathic  
Medical College & Hospital M.I.D.C.  
Latur



.....<sup>Latur</sup> INDUSTRIAL AREA.  
 Village Wadajanti Tq ..... Dist Latur  
 SCALE: 1 C. M. = 200 ..... MTS.

28

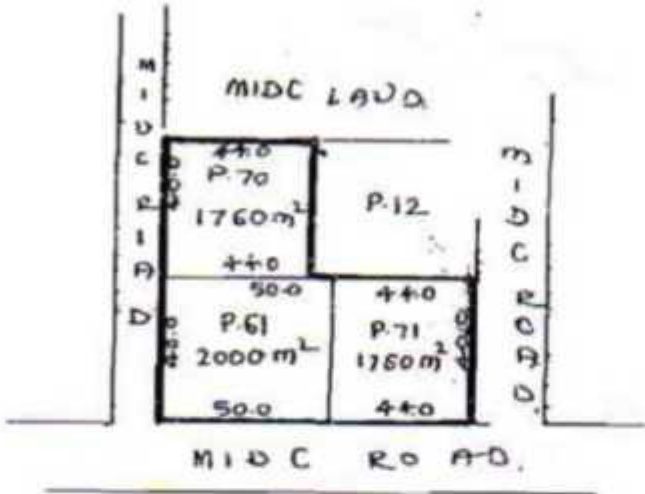

Copied by  
Campe  
 V. D. Trimukhey  
 Surveyor  
 R. O. M. I. D. C.  
 LATUR 413531



*(Handwritten signature)*  
 किसान शिक्षण एकाधिक प्रकल्प  
 सोरगाव, काळेपूर, जि. लतूर

*(Handwritten signature)*  
 S. S. Sawant  
 Regional Officer  
 M. I. D. C. LATUR

*(Handwritten signature)*  
 Principal  
 Vasanttrao Kale Homoeopathic  
 Medical College, M.I.D.C., Latur

Principal  
 Vasanttrao Kale Homoeopathic  
 Medical College & Hospital M.I.D.C.  
 Latur

*(Handwritten signature)*  
 Principal  
 Vasanttrao Kale Homoeopathic  
 Medical College, M.I.D.C., Latur

*(Handwritten signature)*  
 Principal  
 Vasanttrao Kale Homoeopathic  
 Medical College & Hospital M.I.D.C.  
 Latur

KINDA IAN: MK NAIK. Govt Audit

**Maharashtra Industrial Development Corporation**

( A Government Of Maharashtra Undertaking )

Tel : +91-2382-220220

Fax : +91-2382-220934

E-mail : [rolatur@midcindia.org](mailto:rolatur@midcindia.org)

Regional Office, Latur  
C.F.C. Building,  
MIDC Industrial Area,

LATUR  
413512

29

No. RLT/LTR/Case No. 763/4587

Date : 22-Nov-2005

Sub : LATUR INDUSTRIAL AREA  
Allotment of land at...

Ref : Application dated 07-Nov-2005 received from  
**SECRETARY, M/S. KISAN SHIKSHAN PRASARAK MANDAL**

**: ORDER :**

Sanction is hereby accorded to the allotment of land admeasuring 2520 Square Meters comprising of Plot No. P-79 in LATUR INDUSTRIAL AREA to Secretary, M/S. KISAN SHIKSHAN PRASARAK MANDAL BORGADON (KALE) TQ. DIST. LATUR for setting up of your Educational Purpose of HOSPITAL & HOSTEL.

Subject to the payment of the premium of Rs.567,000/- calculated at the rate of Rs.225.00/- per Square Meter and subject to the following conditions.

1. The amount of earnest money received with the application will be appropriated towards the amount of premium. The allottee shall pay the sum of Rs.283,500/- ( Rs. Two lakh eighty three thousand five hundred only ) being the balance amount of the premium within a period of 30 days from the date of receipt of this order, by DD, drawn in favor of MIDC, Latur Payable on any branch at Latur
2. In case the allottee fails to pay the balance amount of premium within the period mentioned above, the allotment shall be liable to be cancelled without further notice.
3. In the event of the allotment being cancelled as foresaid the corporation will be entitled to forfeit the whole of the earnest money received with the application.
4. The terms & conditions of allotment of land will be those contained in the standard form of agreement to lease and the lease annexed thereto & in substance are as follows.
  - a) The allottee shall enter into an agreement to lease in the form prescribed by Corporation & on performance of the conditions will be entitled to lease for term of ninety five (95) years to be computed from the date of execution of the agreement to lease and renewable for one further term 95 years on payment of premium and on such terms and conditions as may be determined by the Corporation at the time of renewal.
  - b) The annual ground rate rent of Rupees 1/- per annum is payable in respect of the plot of land allotted.
  - c) The allottee shall get the plan and specification of the proposed factory building duly approved from the Executive Engineer of the said Industrial area and complete the said building in accordance with approved plans and shall obtain a completion certificate from the Executive Engineer of the said industrial area

Principal

Vasant Rao Kale Homoeopathic  
Medical College & Hospital M.I.D.C.  
Latur

Page 1 of 2

Principal

Vasant Rao Kale Homoeopathic  
Medical College & Hospital M.I.D.C.  
Latur

1/2



- d) The allottee shall not directly or indirectly transfer or assign the benefits of interest in the agreement lease or part with possession of the land or any part thereof without previous consent of the corporation who may refuse or grant it subject to such condition as the corporation may think fit including a condition for payment of additional premium.
- e) The allottee shall be entitled to use land for the purpose of a factory but not for the purpose of a factory for any of the obnoxious industries specified in the annexure set out in the schedule to the agreement to lease and shall not use the said land or any part thereof for an other purpose not for the purpose of any factory which may be obnoxious, offensive by reason of emission of odor, liquid effluvia, dust, smoke, gas, nuisance, vibration or fire hazards.
- f) The other terms and conditions of allotment shall be those contained in the prescribed form of agreement to lease & the lease.
- g) The stamp duty in respect of preparation & execution of the agreement to lease & its duplication as also the lease & its duplication in respect of the allotted plot of land as also the legal costs for the preparation and execution of these documents including the registration fees shall be borne and paid by the allottee alone within a prescribed period.

h) The Allotment Order is issued subject to Consent From MPCB and Permission from FDA Department.

i) Plot No. P-79 admeasuring 2520 sqm. has fenced from barbid wire the cost of the same should be paid by you and the same will be communicated separately.

The allottee may submit his application for telephone connection to the concern telephone authority immediately, after taking over the possession of the plot. This will enable the telephone authorities to build up a waiting list & ensure proper planning to provide timely telephone connection to the industrial units in the area.

Please also note A to L will be signed with you within 30 days from the date of receipt of Balance Occupancy Premium Amount.

*[Signature]*  
Regional Officer,  
MIDC, LATUR  
22/11

To,  
Secretary  
M/S. KISAN SHIKSHAN PRASARAK MANDAL, BORGAON (KALE)  
C/O. PLOT NO. P-12  
MIDC INDL AREA  
LATUR

- Copy submitted to :
- 1) The Dy. Chief Account Officer, MIDC, Aurangabad.
  - 2) The Chief Planner, MIDC, Mumbai - 400 093.
  - 3) The Technical Advisor, MIDC, Mumbai - 400 093.
  - 4) Executive Engineer MIDC Division, Latur

Copy f.w.c.s to :  
1. Dy. Engineer, SPA, Latur.

Copy to :  
1. Head Surveyor / Surveyor Regional Office MIDC, LATUR

*[Signature]*  
Regional Officer,  
MIDC, LATUR  
22/11

Principal Vasant Rao Kale Homoeopathic Medical College & Hospital M.I.D.C. Latur

Principal Vasant Rao Kale Homoeopathic Medical College & Hospital M.I.D.C. Latur

Principal Vasant Rao Kale Homoeopathic Medical College & Hospital M.I.D.C. Latur

(31)

Latur INDUSTRIAL AREA  
Village Waxwaxta Dist Latur  
Plot No. P-79 Area 2520 m<sup>2</sup>

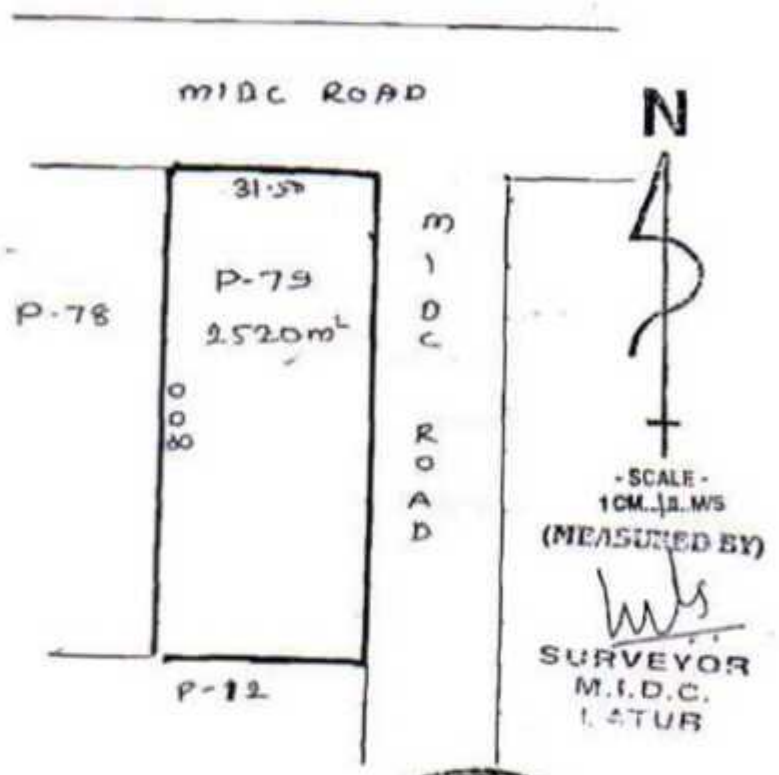

Ganesh J.  
सचिव  
किसान विकास साक मंडळ  
बोलाय ( १७२६ ) वा. लि. लतूर

[Signature]  
[Stamp]  
Latur

Principal  
Vasentrao Kale Homoeopathic  
Medical College & Hospital M.I.D.C.  
Latur

Principal  
Vasentrao Kale Homoeopathic  
Medical College & Hospital M.I.D.C.  
Latur

Principal  
Vasentrao Kale Homoeopathic  
Medical College & Hospital M.I.D.C. Latur

Vasentrao Kale  
Medical College & Hospital  
Latur